

Rev.	Description	Date
1	New Release	3/9/05
2	Updated	2/1/08

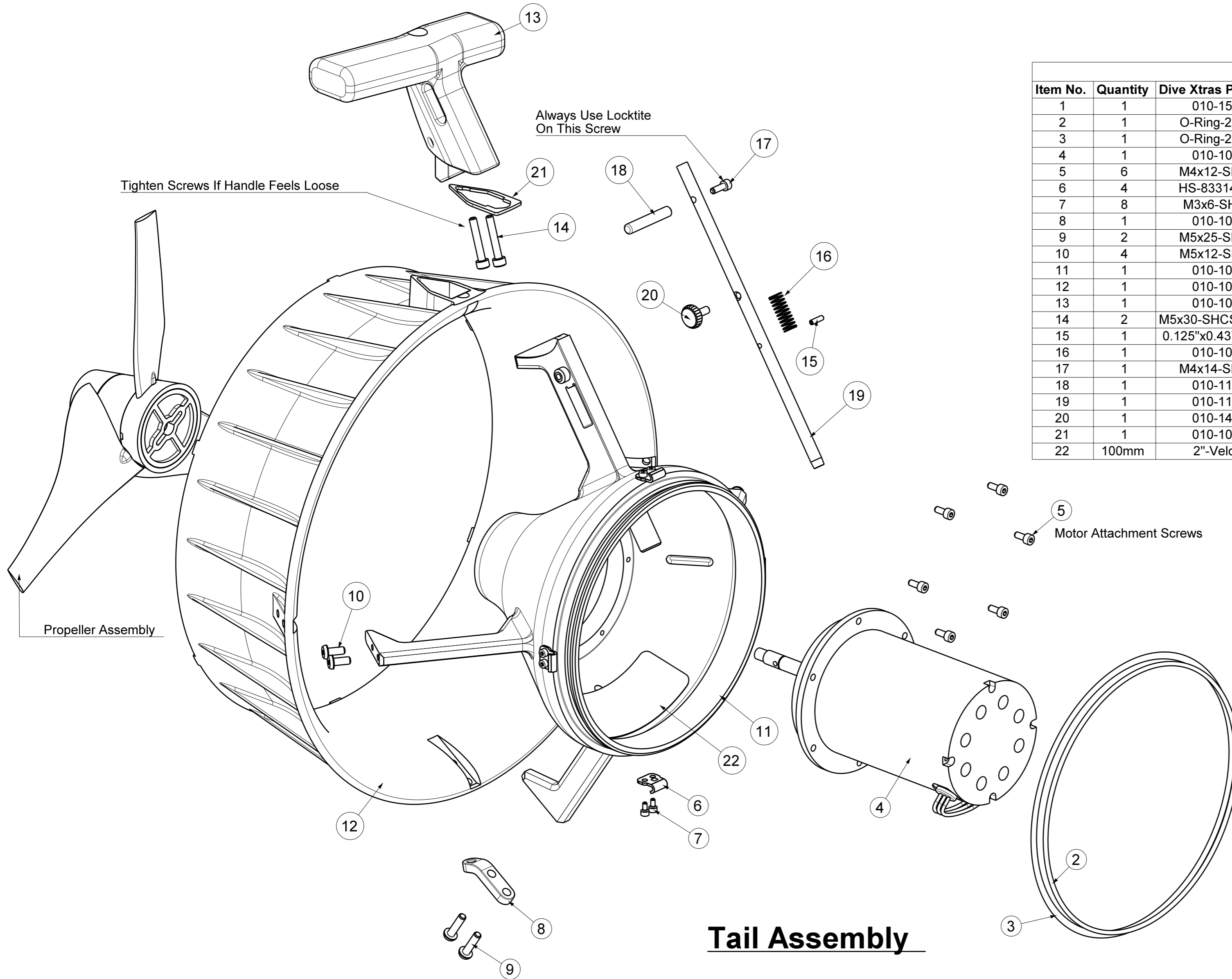

Tail Assembly			
Item No.	Quantity	Dive Xtras Part No.	Description
1	1	010-1500	Electronic Relay Assembly, Sierra
2	1	O-Ring-2-261	O Ring, 2-261, Nitrile
3	1	O-Ring-2-263	O Ring, 2-263, Nitrile
4	1	010-1007	Motor.
5	6	M4x12-SHCS	M4 x 12 Metric Socket Head Cap Screw, 316 Stainless steel
6	4	HS-83314-SS	Strike Plate.
7	8	M3x6-SHCS	M3 x 6 Metric Socket Head Cap Screw, 316 Stainless Steel
8	1	010-1003	Lower Handle, Tail.
9	2	M5x25-SHCS	M5 x 25 Metric Socket Head Cap Screw, 316 Stainless Steel
10	4	M5x12-SHBS	M5 x 12 Metric Socket Head Button Screw, 316 Stainless Steel
11	1	010-1001	Weldment Tail
12	1	010-1004	Shroud, Prop.
13	1	010-1002	Handle, Tail.
14	2	M5x30-SHCS	M5 x 30 Metric Socket Head Cap Screw, 316 Stainless Steel
15	1	0.125"x0.4375"-SP	Stainless Spring Pin, 1/8" Dia, 7/16" Lg, 18-8 Stainless Steel.
16	1	010-1005	Compression Spring.
17	1	M4x14-SHCS	M4 x 14 Metric Socket Head Cap Screw, 316 Stainless steel
18	1	010-1103	Trigger, Trigger.
19	1	010-1150	Control Rod Assembly, Trigger.
20	1	010-1400	Locking Screw, Trigger.
21	1	010-1013	Handle, Shim
22	100mm	2"-Velcro	Adhesive Velcro Strip 2"

**Reed Switch Positioning.**

The position of the reed switch on its shaft is important to ensure correct operation of the trigger. When repositioning, ensure trigger activates at about 50% travel and that it stays activated at 100% travel.

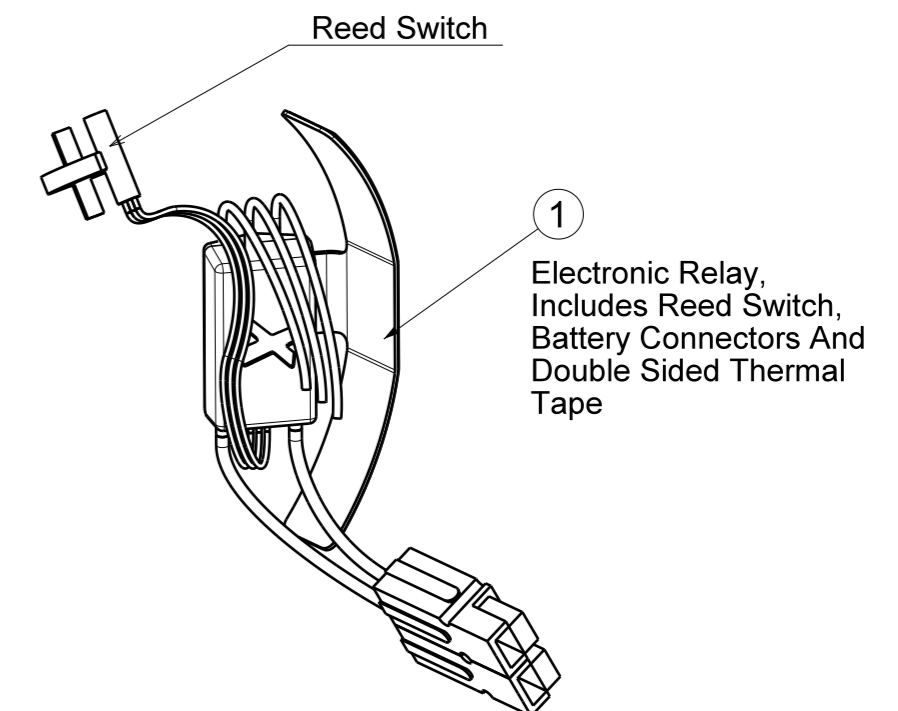

**Tail Assembly**

**diveX** © DIVE XTRAS 2008 ALL RIGHTS RESERVED  
 THIS DOCUMENT IS SUPPLIED IN CONFIDENCE. NO REPRODUCTION OF THE DOCUMENT OR ANY PART OF IT OR OF THE ITEMS SHOWN THEREON MAY BE MADE WITHOUT THE COPYRIGHT OWNERS WRITTEN PERMISSION.

THIRD ANGLE PROJECTION

All dimensions are in mm. Deburr & Break all sharp edges

Engineer: **Ben McGeever**

**Tail Assembly Exploded View**

Drawing No:	Rev	Sheet
xxx	1	1